

■ **Compression joint, full tension, Al 25 - 95 mm²**

- For full tension connections of Aldrey cables according to DIN EN 50182



Characteristics

- With buttmarks for precise cable insertion
- Tube dimensions matched to aluminium steel cables
- With markings for correct crimping

Material

- AlMgSi F20

Surface

- bright



Cross-section mm ²	Part No.	Code	Conductor Ø mm	Dimensions mm		Number of crimps		Weight/100 pcs. ~ kg	pcs.
				d1	l	mech.	hydr.		
25	294AD	12	6.3	6.8	140	8/8	--	3.4	5
35	295AD	14	7.5	8.0	140	8/8	--	4.7	5
50	296AD	16	9.0	10.0	155	8/8	--	5.9	5
70	297AD	18	10.5	11.5	165	8/8	--	9.0	5
95	298AD	20	12.5	13.5	165	10/10	5/5	10.2	5

▶ Tool: see chart page 112

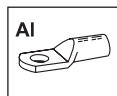

■ **Compression cable lugs, Al/St 4 - 120 mm²**

- For aluminium/steel cables to DIN EN 50182



Characteristics

- Tube dimension matched to aluminium steel cables
- With markings for correct crimping

Material

- E-Al

Surface

- bright

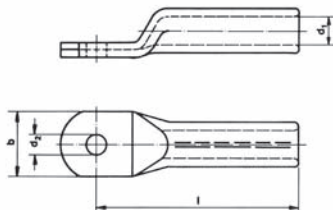

Cross-section mm ²	Size of bolt Ø	Part No.	Code	Conductor Ø mm	Dimensions mm				Weight/100 pcs. ~ kg	pcs.
					d1	d2	b	l		
25 - 4	M 8	254R8	12	6.8	7.6	8.5	19	60	1.5	5
	M 10	254R10	12	6.8	7.6	10.5	19	60	1.5	5
	M 12	254R12	12	6.8	7.6	13.0	23	60	1.6	5
35 - 6	M 10	255R10	14	8.1	9.0	10.5	21	67	2.0	5
	M 12	255R12	14	8.1	9.0	13.0	21	67	2.2	5
50 - 8	M 10	256R10	16	9.6	10.8	10.5	22	72	2.5	5
	M 12	256R12	16	9.6	10.8	13.0	24	72	2.6	5
	M 16	256R16	16	9.6	10.8	17.0	26	72	2.7	5
70 - 12	M 10	257R10	18	11.7	12.5	10.5	26	86	4.1	5
	M 12	257R12	18	11.7	12.5	13.0	26	86	4.3	5
	M 16	257R16	18	11.7	12.5	17.0	32	86	4.4	5

■ **Compression cable lugs, Al/St 4 - 120 mm²**

Cross-section mm ²	Size of bolt Ø	Part No.	Code	Conductor Ø mm	Dimensions mm				Weight/ 100 pcs. ~ kg	pcs.
					d1	d2	b	l		
95 - 15	M 12	258R12	22	13.6	14.8	13.0	31	91	7.8	5
	M 16	258R16	22	13.6	14.8	17.0	33	91	6.6	5
120 - 20	M 12	259R12	25	15.5	16.5	13.0	37	103	9.8	5
	M 16	259R16	25	15.5	16.5	17.0	37	103	10.0	5
	M 20	259R20	25	15.5	16.5	21.0	41	103	10.1	5

► Tool: see chart page 113

■ **Compression joints, Al/St 4 - 120 mm²**

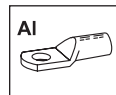

■ For non-tension connections of Al/St cables to DIN EN 50182



Characteristics

- With buttmarks for precise cable insertion
- With markings for correct crimping

Material

- E-Al

Surface

- bright



Cross-section mm ²	Part No.	Code	Conductor Ø mm	Dimensions mm		Number of crimps		Weight/ 100 pcs. ~ kg	pcs.
				d1	l	mech.	hydr.		
25 - 4	444R	12	6.8	7.6	70	4/4	2/2	1.65	5
35 - 6	445R	14	8.1	9.0	85	5/5	2/2	2.75	5
50 - 8	446R	16	9.6	10.8	85	5/5	2/2	3.70	5
70 - 12	447R	18	11.7	12.5	105	6/6	3/3	5.20	5
95 - 15	448R	22	13.6	14.8	105	6/6	3/3	8.60	5
120 - 20	449R	25	15.5	16.5	125	6/6	3/3	12.20	5

► Tool: see chart page 113

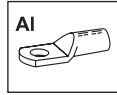

■ **Compression joints to DIN, Al/St 4 - 120 mm²**

■ **For full tension connections of Al/St conductors to DIN EN 50182**



Characteristics

- Manufactured according to DIN 48085, part 3
- With markings for correct crimping

Material

- Al sleeve: E-Al
- St sleeve: St 52

Surface

- Al sleeve: bright
- St sleeve: hot galvanised

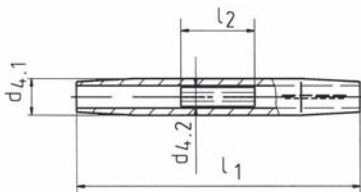

Cross-section mm ²	Part No.	Conductor Ø mm	Code	Dimensions mm		Number of crimps		Code	Dimensions mm		Number of crimps		Weight/100 pcs. ~ kg	pcs.
				d4.1	l1	mech.	hydr.		d4.2	l2	mech.	hydr.		
25 - 4	454R	6.8	12	12.0	200	7/7	--	6	6.3	65	4/4	--	5	5
35 - 6	455R	8.1	14	14.0	235	8/8	--	6	6.3	75	5/5	--	7	5
50 - 8	456R	9.6	16	16.0	270	9/9	--	7	7.5	95	6/6	--	11	5
70 - 12	457R	11.7	18	18.5	270	9/9	--	9	9.5	95	6/6	--	15	5
95 - 15	458R	13.6	22	22.5	310	11/11	--	9	9.6	95	6/6	--	23	5
120 - 20	459R	15.5	25	25.0	380	13/13	6/6	13	13.0	110	7/7	4/4	36	5

▶ Tool: see chart page 113

■ **Bi-metallic washer, M8 - M16**

■ **For use with Al and Cu materials**



Characteristics

- Only for use in dry areas

Material

- E-Al, one side copper plated

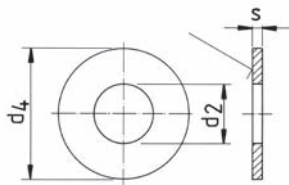

Size of bolt Ø	Part No.	Dimensions mm			Weight/100 pcs. ~ kg	pcs.
		d4	d2	s		
M 8	CS818	18	8.5	1	0.09	10
M 10	CS1022	22	11.0	2	0.26	10
M 12	CS1228	28	13.0	2	0.44	10
M 14	CS1428	28	15.0	2	0.40	10
M 16	CS1635	35	17.0	2	0.66	10