

**Insulated solderless terminals, copper, 10 - 150 mm<sup>2</sup>**  
Ring type

■ For conductors, e.g. to VDE 0295 Class 2, 5 and 6

**Characteristics**

- Insulating sleeve PA, free of halide with easy-entry cable insertion
- Dimensions in tube according to DIN 46234
- With grooved profile
- Hard-soldered in the crimping area

**Material**

- Cu-ETP

**Surface**

- tin plated

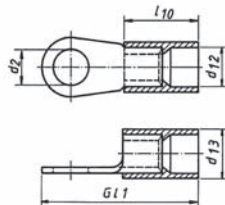

Cross-section mm <sup>2</sup>	Part No.	Colour	Dimensions mm					Weight		pcs.
			d13	d2	d12	G11	l10	100 pcs. ~ kg Cu	Total	
10	6525	■	8.6	5.3	6.7	34.0	19.0	0.27	0.27	100
	6526	■	8.6	6.5	6.7	34.0	19.0	0.24	0.28	100
	6528	■	8.6	8.4	6.7	37.5	19.0	0.29	0.33	100
	65210	■	8.6	10.5	6.7	41.5	19.0	0.34	0.38	100
	65212	■	8.6	13.0	6.7	45.5	19.0	0.42	0.46	100
16	6535	■	9.6	5.3	7.7	39.5	20.5	0.39	0.44	100
	6536	■	9.6	6.5	7.7	39.5	20.5	0.38	0.43	100
	6538	■	9.6	8.4	7.7	41.5	20.5	0.43	0.48	100
	65310	■	9.6	10.5	7.7	43.5	20.5	0.50	0.55	100
	65312	■	9.6	13.0	7.7	50.5	20.5	0.58	0.63	100
25	6545	■	13.0	5.3	11.0	40.0	20.0	0.75	0.84	50
	6546	■	13.0	6.5	11.0	42.5	20.0	0.69	0.78	50
	6548	■	13.0	8.4	11.0	43.0	20.0	0.75	0.84	50
	65410	■	13.0	10.5	11.0	45.0	20.0	0.80	0.89	50
	65412	■	13.0	13.0	11.0	51.0	20.0	0.92	1.00	50
	65416	■	13.0	17.0	11.0	59.0	20.0	1.32	1.40	50
35	6556	■	15.0	6.5	12.7	44.0	22.5	1.01	1.14	50
	6558	■	15.0	8.4	12.7	44.5	22.5	0.98	1.10	50
	65510	■	15.0	10.5	12.7	46.5	22.5	1.00	1.12	50
	65512	■	15.0	13.0	12.7	52.5	22.5	1.26	1.38	50
	65516	■	15.0	17.0	12.7	54.5	22.5	1.55	1.67	50
50	6566	■	18.0	6.5	15.4	54.5	27.5	1.65	1.90	50
	6568	■	18.0	8.4	15.4	60.5	27.5	1.65	1.90	50
	65610	■	18.0	10.5	15.4	60.5	27.5	1.60	1.85	50
	65612	■	18.0	13.0	15.4	60.5	27.5	1.80	2.05	50
	65616	■	18.0	17.0	15.4	67.5	27.5	2.10	2.35	50
70	6576	■	20.0	6.5	17.4	61.5	30.5	2.60	2.90	50
	6578	■	20.0	8.4	17.4	61.5	30.5	2.50	2.80	50
	65710	■	20.0	10.5	17.4	66.5	30.5	2.50	2.80	50
	65712	■	20.0	13.0	17.4	66.5	30.5	2.40	2.70	50
	65716	■	20.0	17.0	17.4	70.5	30.5	2.70	3.00	50
95	65810	■	23.5	10.5	20.5	70.0	34.0	4.10	4.50	25
	65812	■	23.5	13.0	20.5	70.0	34.0	3.90	4.40	25
	65816	■	23.5	17.0	20.5	76.0	34.0	4.10	4.50	25
120	65910	■	26.7	10.5	23.5	79.0	36.0	5.60	6.10	25
	65912	■	26.7	13.0	23.5	82.0	36.0	5.40	5.90	25
	65916	■	26.7	17.0	23.5	90.0	36.0	5.80	6.30	25

**Insulated solderless terminals, copper, 10 - 150 mm<sup>2</sup>**

Ring type

Cross-section mm <sup>2</sup>	Part No.	Colour	Dimensions mm					Weight		pcs.
			d13	d2	d12	Gl1	l10	100 pcs. ~ Cu	kg Total	
150	<b>66010</b>	■	29.2	10.5	26.0	80.0	39.0	7.60	8.40	25
	<b>66012</b>	■	29.2	13.0	26.0	83.0	39.0	7.60	8.40	25
	<b>66016</b>	■	29.2	17.0	26.0	83.0	39.0	7.50	8.30	25

▶ Tool: see chart page 89

**Insulated pin terminals, copper, 10 - 95 mm<sup>2</sup>**

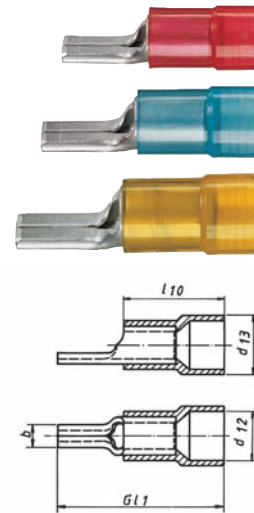
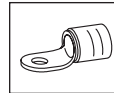

- For conductors, e.g. VDE 0395, Class 2
- Crimping operation on the insulation itself

**Characteristics**

- Insulating sleeve PA, free of halide
- Hard-soldered in the crimping area
- Insulating sleeve PA, free of halide with easy-entry cable insertion

**Material**

- Cu-ETP

**Surface**

- tin plated

Cross-section mm <sup>2</sup>	Part No.	Colour	Dimensions mm					Weight		pcs.
			d13	d12	b	Gl1	l10	100 pcs. ~ Cu	kg Total	
10	<b>ST1716IS</b>	■	9.4	7.4	4.3	33.0	19.0	0.27	0.31	100
16	<b>ST1717IS</b>	■	10.6	8.6	5.5	38.0	20.0	0.39	0.44	100
25	<b>ST1718IS</b>	■	14.5	12.5	6.8	43.5	23.5	0.63	0.73	50
35	<b>ST1719IS</b>	■	16.4	14.0	8.0	51.5	27.5	1.17	1.34	50
50	<b>ST1720IS</b>	■	18.0	15.5	9.5	59.0	33.0	1.79	2.10	50
70	<b>ST1721IS</b>	■	20.5	18.0	11.0	69.0	38.0	2.92	3.20	50
95	<b>ST1722IS</b>	■	23.5	20.7	12.5	71.0	40.0	4.30	4.70	25

▶ Tool: see chart page 89